

# ▲ TEAL TRIANGLE

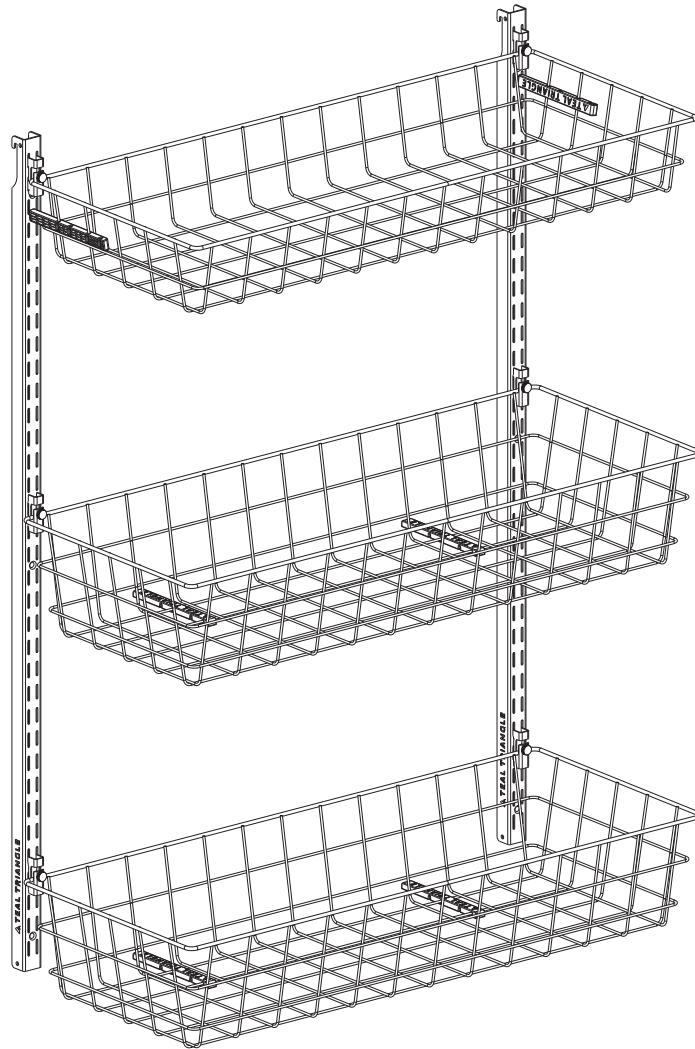

## INSTALLATION GUIDE

### G-SYSTEM BASKETS



SCAN THIS QR CODE FOR  
THE FULL INSTALL VIDEO.

Questions or Concerns?

Contact us at:  [support@tealtriangle.com](mailto:support@tealtriangle.com)

# IMPORTANT INFORMATION

---

G+ 3 Basket Kit

Manufactured for Spire LLC in Vietnam

Quantity: 1

**WARNING! The product is NOT intended for use by any person under the age of 18 years old. You must be over the age of 18 to install or use the product.**

**WARNING! Strictly follow all instructions to avoid an accident, damage to property, personal injury or death.**

**WARNING! Do not use this product for human suspension. Components can fail causing person to fall, possibly resulting in serious injury or death.**

**WARNING! When operating system, make sure the area below object is clear of persons. If object comes down too quickly, this can cause an accident.**

## **READ THE ENTIRE USER MANUAL BEFORE INSTALLATION**

The User Manual you received with your product provides instructions on how to install and use your product. The instructions are written for a person with a basic understanding of tools and procedures. Read the entire manual before proceeding. If you do not understand any portion of the instructions, do not attempt installation, and email [support@tealtriangle.com](mailto:support@tealtriangle.com).

## **CORRECTLY INSTALL THE PRODUCT**

Read and follow all instructions carefully.

Failure to properly install and use the product could allow the product to dismantle or tip over, injuring persons or personal property in the process. Accordingly, it is critical that the product be installed correctly and according to the instructions in the User Manual.

## **USE TOOLS SAFELY**

The procedures in the User Manual may require climbing ladders and/or operating power tools. Make sure you are familiar with these tools and their safety procedures before attempting to use such tools during installation. Always be aware of electrical wires during installation. Failure to do so could result in an electrical shock or death.

## **CAUTION**

It is the consumer's responsibility to install this system in accordance with all codes, ordinances, and local regulations.

When installing the product, it is the consumer's responsibility to ensure the structural integrity of the structure it is being mounted to.

The product is intended for the storage of sporting equipment only. Do not use it for any other purpose.

This system has a maximum capacity listed in the next section. Overloading the system could result in damage to property or injury.

Use extreme caution when loading and unloading equipment from this system.

It is the consumer's responsibility to ensure that the system is in proper working condition before loading objects onto the system. Check tightness of all bolts and screws periodically. Failure to properly maintain the system could result in damage to property or injury.

## **WARNING AND DISCLAIMER**

Spire LLC (d/b/a Teal Triangle) expressly disclaims any and all liability for personal injury, property damage or loss, whether direct, indirect, incidental, resulting from the incorrect mounting, improper use, inadequate maintenance, or neglect of this system.

# G-SYSTEM PARTS

## REQUIRED TOOLS:

Stud Finder  
Drill/Impact Driver  
Phillips Head Screwdriver  
3/32" (2.5mm) Drill Bit  
Pencil

## WEIGHT LIMITS:

40 lbs. max per basket  
200 lbs. max total

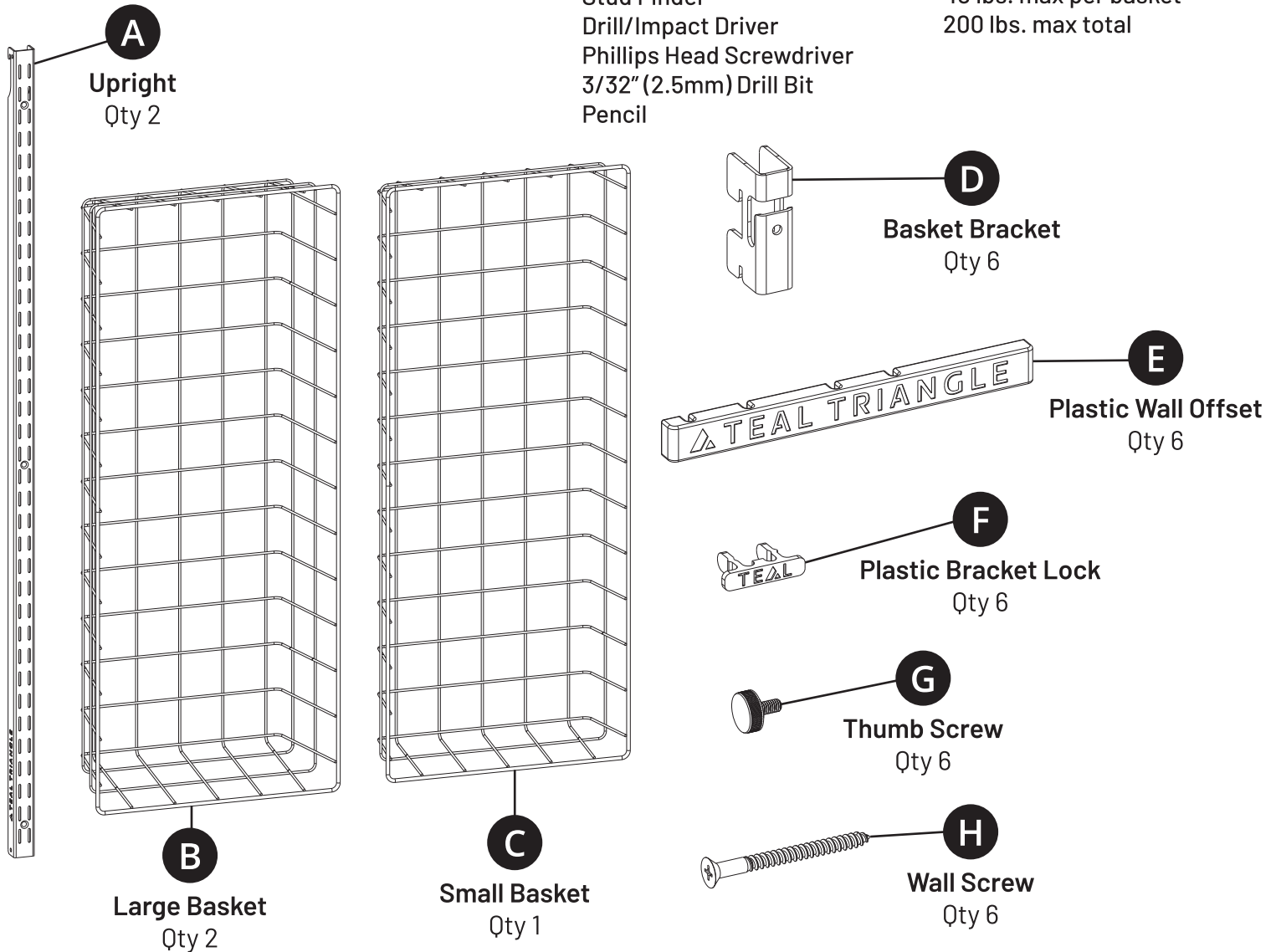

## INSTALLATION

1

**Locate and Mark the Studs:** Start by finding the studs in your wall. We recommend marking three studs that are 32" apart for 16" spacing or 24" apart for 24" spacing. You can use a stud finder for this task.

2

**Determine Mounting Height:** The Uprights (A) for your product are 45" long. Decide how high you want to mount them on the wall. This will depend on what you plan to store on the product and your personal preference.

3

**Mark the Upright Position:** Once you've decided on the height, mark where the top of the upright will intersect with the studs. Remember, the top of the uprights has cutouts on the side, so ensure this section is facing towards the ceiling.

4

**Drill the First Hole:** Using a  $3/32$ " drill bit, drill a hole 3" below the mark you made for the top of the Upright (A).

5

**Mount the Upright:** Use a Wall Screw (H) to mount the Upright (A) to the wall using only the top mounting hole. Do not fully tighten the screw yet as you may need to make adjustments.

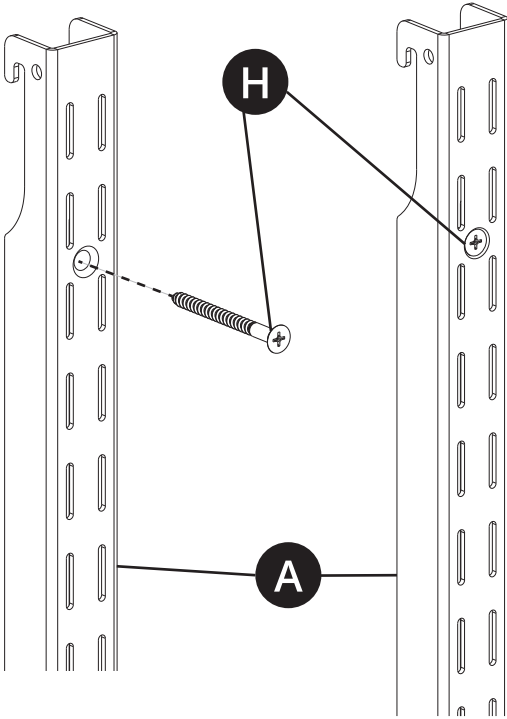

6

**Drill Mounting Holes:** Use a level to ensure the Upright (A) is vertical and aligned with the stud. Once it's level, use a  $3/32$ " (2.5mm) drill bit to drill pilot holes through the other two mounting holes in the upright - one in the middle and one toward the bottom.

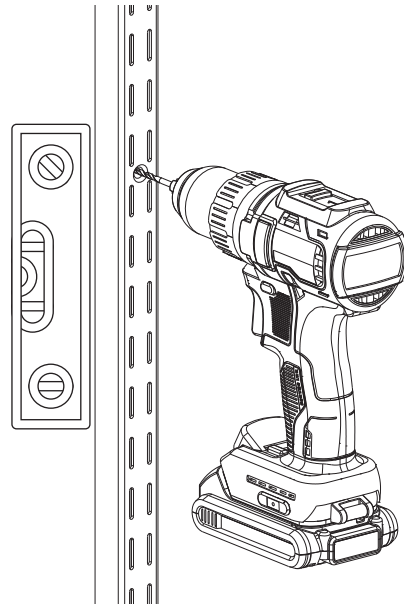

7

**Secure the Upright:** Use Wall Screws (H) to mount the upright into the holes you just drilled. Now you can fully tighten all the screws.

8

**Repeat for the Other Upright:** Repeat the marking, drilling, and mounting process for the other Upright (A). Make sure the two uprights are level with the wall and each other.

9

**Install the Basket Brackets:** Install the Basket Brackets (D) into the Uprights (A) at the location where you want the Basket (B or C). Use a Plastic Locking Clip (F) to lock it in place. Ensure the brackets are in the same position on each upright.

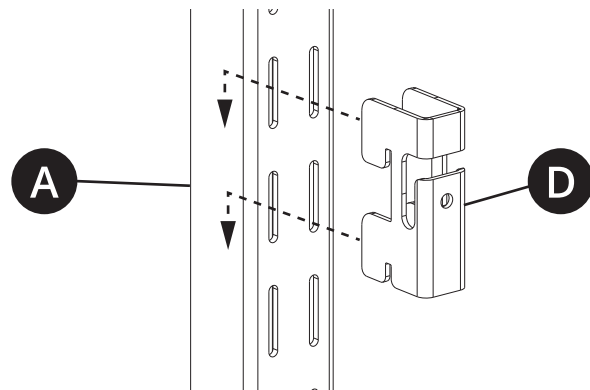

10

**Install the Basket:** Slide the horizontal wire of the Basket (B or C) into the cutout slot of the Bracket (D). Use a Thumb Screw (G) in the hole on the front to prevent the basket from coming out of the bracket.

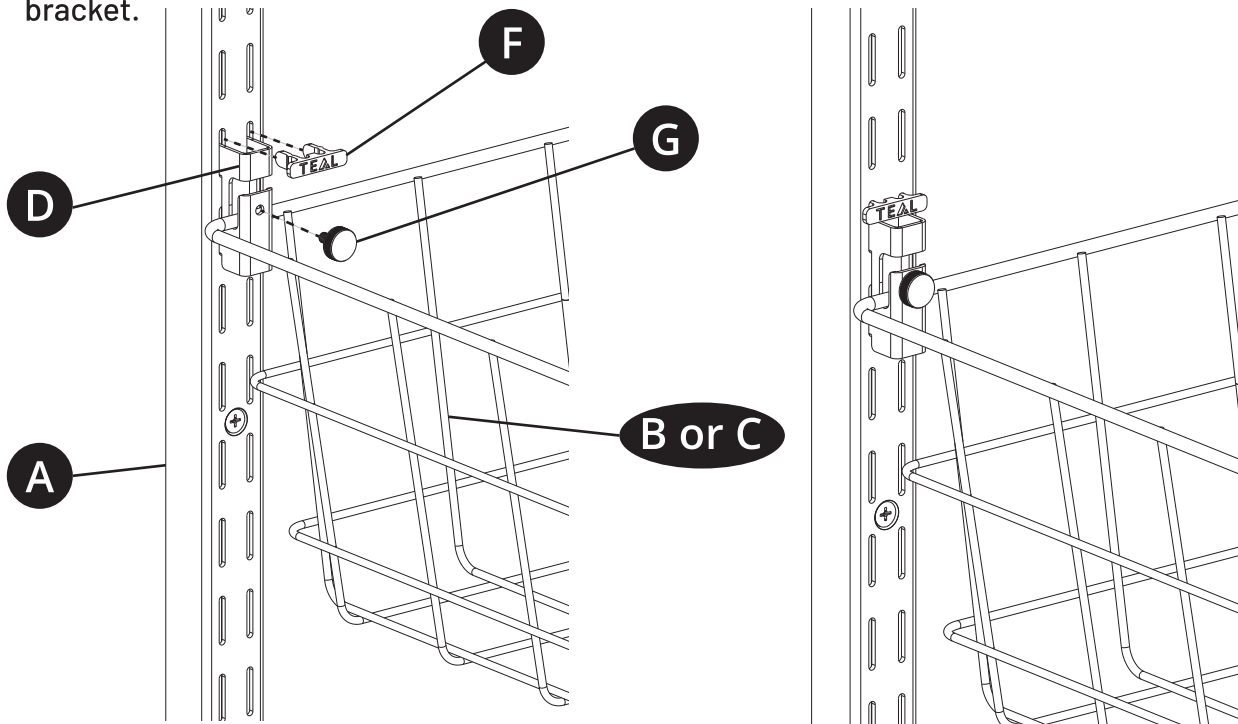

11

**Use a Plastic Wall Offset:** Use a Plastic Wall Offset (E) to hold the basket horizontal. These can be positioned on the bottom to hold the basket against a wall (left image), or they can be positioned on the sides to hold the basket against the upright (right image). Ensure they snap tightly onto the wire of the basket.

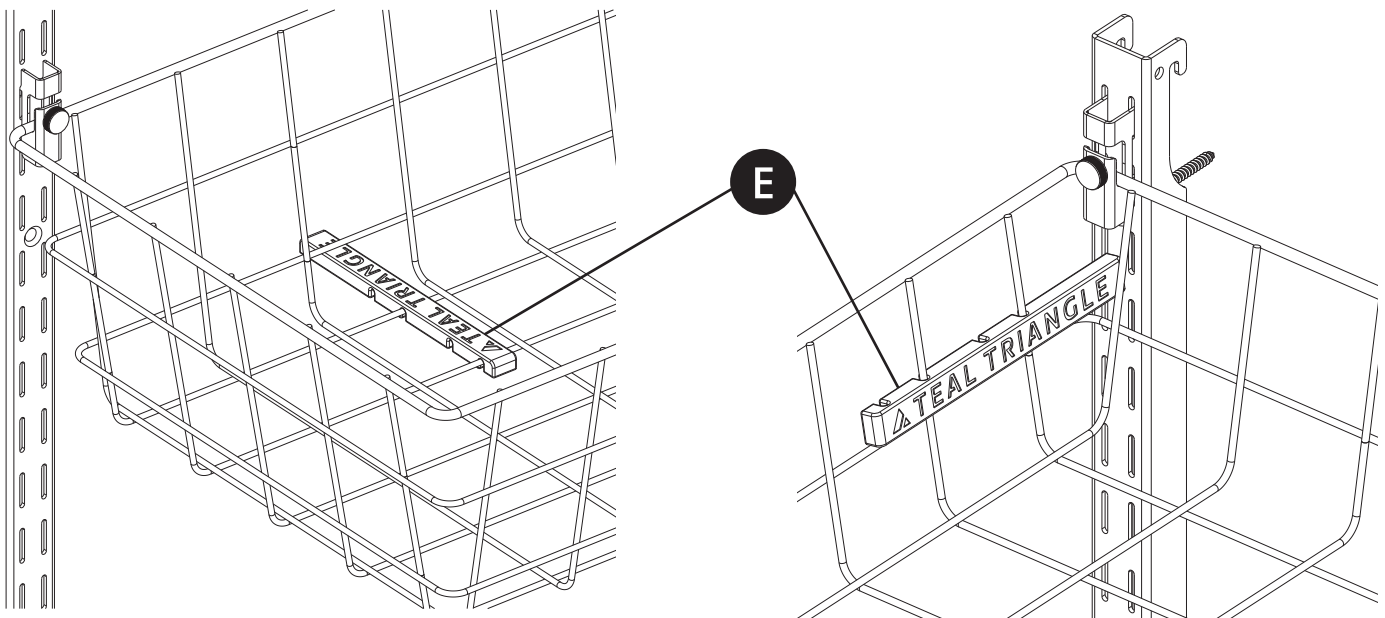

12

**Repeat for Other Baskets:** Repeat the process for any other baskets you want to install. If you want to move the baskets to a different level, remove the plastic lock clip from the upright, slide the bracket and basket assembly up and out of the upright, reposition it, and reinstall the plastic lock clip.